

Issue 1

PRO-TFD20

Item	Qty	Description
A	1	PRO-TFD20 STEP
B	6	M12 x 55 Grade 10.9 Bolts & Nyloc Nuts
C	6	12 x 25 Flat Washers
D	6	12 x 30 Flat Washers

1. Using Item B with Item C loosely fix the Towbar Crossmember between each side arm at the forward lower mounting point only (No nut and washer at this point, you want to make a stud either side), have the Towbar Crossmember facing the floor this will enable you to slide Item A through the open slot.
2. With the step in place swing the Towbar Crossmember up into position and using Item B with Item C fix Item A through the remaining fixing points, using Item D on the outside face with the nuts provided secure everything in place.
3. Fully tighten all fixings ensuring the Towbar and Pro-Step are rigid, square and secure.

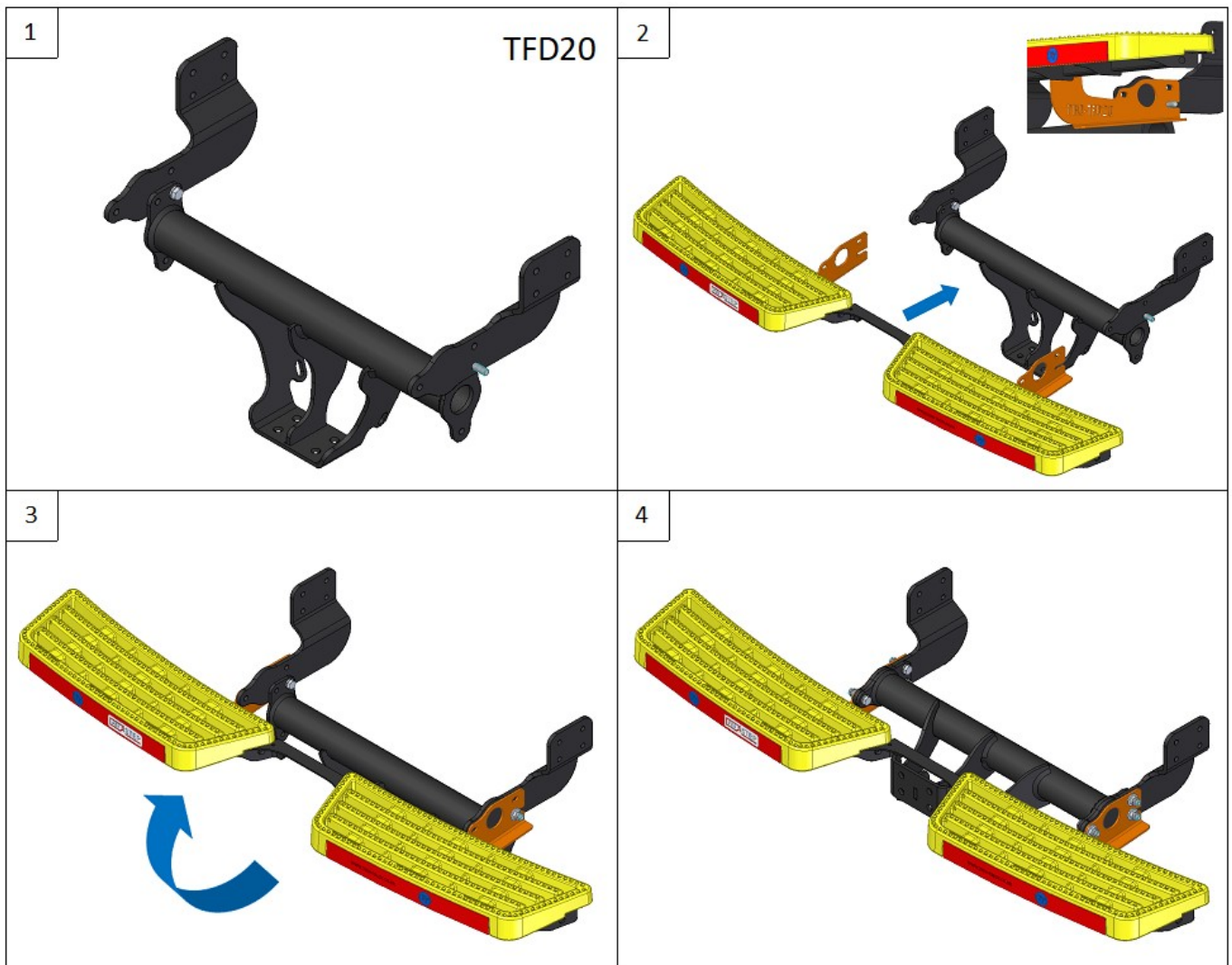

Note:

1. Nose load limits and vehicle manufacturers trailer / caravan weight limits must be observed.